

RECEIVED
23 JUL 2014
CSU MAILROOM

FIRE SAFETY
Daily fire alarm and automatic smoke detection to BS58 P 1 2002

FIRE SIGNAGE
Provide fire signs in accordance with BS499 P 1 2000

Back of House Notice Boards to be positioned where needed

Equality Guidelines
Minimum 850mm pinch point
Minimum 1200mm turning circle
Minimum 850mm gap behind the kiosk frontline to backline
Leading edge on all swing doors to be 300mm minimum
To apply where possible

Fire Escape Route

Change north point to match survey information

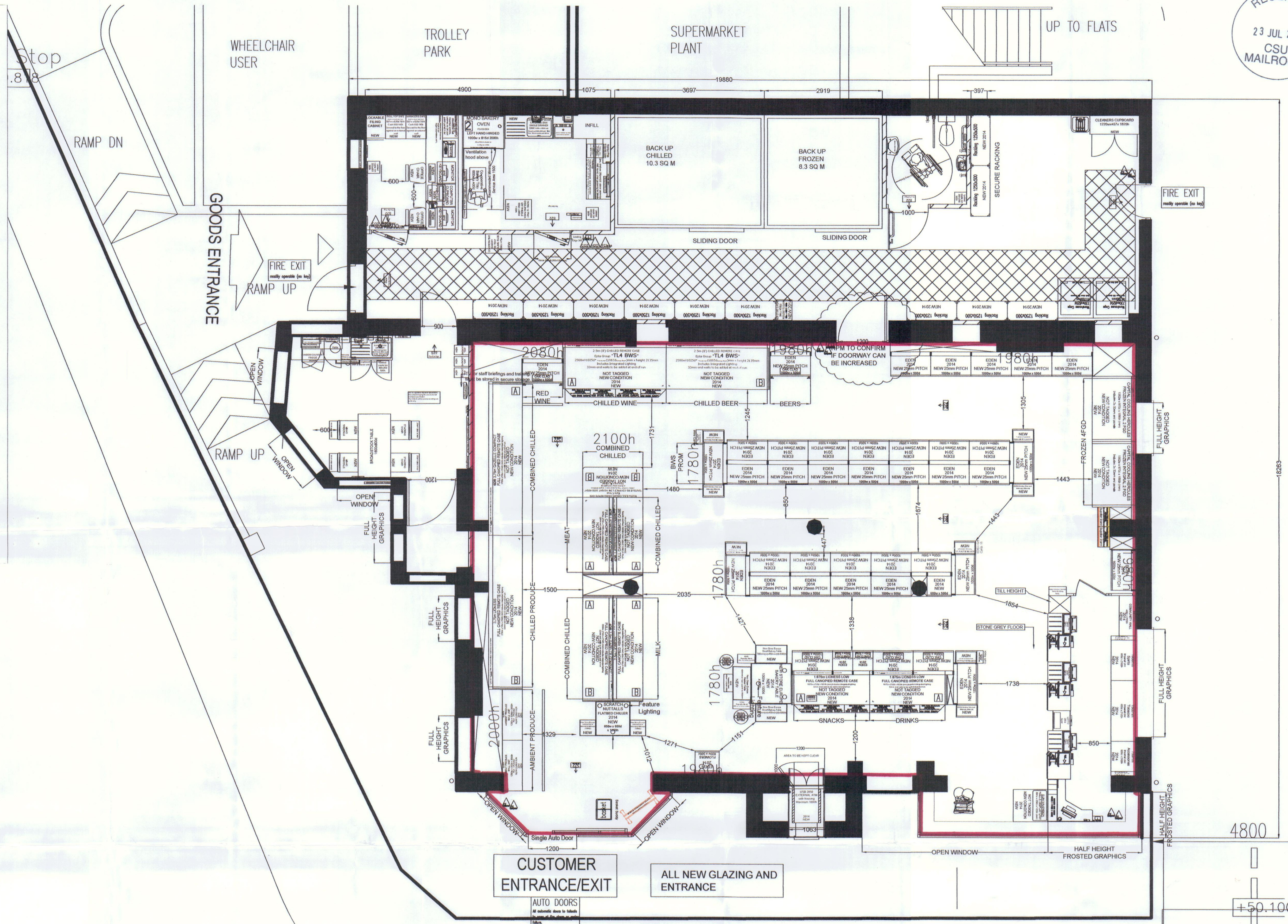

SHOP-FLOOR - 1:50

SURVEY OVERLAID

<p>Description of Amends 26.11.13 - Newhaven - P1F1M0/IGS Initial design proposal 06.12.13 - Newhaven - P1F2M0/IGS Amends made following drawing review; 2 x 1.8 chillers replaced by 2 x 2.5s, ISB/ambient gondola running vertically removed and replaced by gondolas running at 90 degrees to previous, ISB incorporated into snacking island near kiosk, flowers added, frozen moved, bakery table added (replaced 2nd scratch), warehouse door changed to 1200 block, box out added near kiosk, door added to staff room from BOH, kiosk side panel moved, bakery table bag holders x 2 added. 18.12.13 - Newhaven - P1F3M0/IGS Door added to staff room from BOH, kiosk side panel moved, bakery table bag holders x 2 added, chilled island moved 100mm to increase first aisle width to 1500.</p>	<p>23.12.13 - Newhaven - P1F4M0/IGS Maxi moved to managers station, door added in back of house (staff room) to create storage room, window graphics altered on staff room, box out on back line removed, cleaners cupboard/sink reconfigured, mobile community board added</p>	<p>Wall finishes - Format Led Please refer to the <i>Asset Planning Standard/Notes</i> for applicable information. ALL OPERATIONS TO BE OVERSEEN BY THE HSE under their duty imposed by the CDM Regulations 2007 the designers have attempted to eliminate hazards and risks where possible during design and where hazards and risks could not be avoided the designers have reduced the risks as far as possible. The remaining hazards and foreseeable risks that could not be designed out the project have been identified as below. FALLS: from heights during installation of suspended ceilings, taking deliveries over raised loading bays, as a result of split level floors and steps. HAZARDOUS MATERIALS: i.e. asbestos - to be removed as necessary by specialist, see the <i>Co-operative Groups Management of Asbestos Containing Materials</i> policy and processes. Service providers must comply with the <i>Co-operative Groups Management of Asbestos Containing Materials</i> policy and processes. Service providers are to access the <i>Co-operative Groups web-based asbestos register</i>, www.2650online.co.uk, prior to undertaking any works. Any difficulty in obtaining asbestos information must be brought to our immediate attention and is not an excuse for working without this. Management of Asbestos As part of our compliance with the Management of Asbestos Regulations, service providers must comply with the <i>Co-operative Groups Management of Asbestos Containing Materials</i> policy and processes. Service providers are to access the <i>Co-operative Groups web-based asbestos register</i>, www.2650online.co.uk, prior to undertaking any works. Any difficulty in obtaining asbestos information must be brought to our immediate attention and is not an excuse for working without this.</p>	<p>Standard Notes Please refer to the <i>Asset Planning Standard/Notes</i> for applicable information. ALL OPERATIONS TO BE OVERSEEN BY THE HSE under their duty imposed by the CDM Regulations 2007 the designers have attempted to eliminate hazards and risks where possible during design and where hazards and risks could not be avoided the designers have reduced the risks as far as possible. The remaining hazards and foreseeable risks that could not be designed out the project have been identified as below. FALLS: from heights during installation of suspended ceilings, taking deliveries over raised loading bays, as a result of split level floors and steps. HAZARDOUS MATERIALS: i.e. asbestos - to be removed as necessary by specialist, see the <i>Co-operative Groups Management of Asbestos Containing Materials</i> policy and processes. Service providers must comply with the <i>Co-operative Groups Management of Asbestos Containing Materials</i> policy and processes. Service providers are to access the <i>Co-operative Groups web-based asbestos register</i>, www.2650online.co.uk, prior to undertaking any works. Any difficulty in obtaining asbestos information must be brought to our immediate attention and is not an excuse for working without this.</p>	<p>CDM Regulations 2007 The designers at the Co-operative have pointed out that the CDM Regulations 2007 may apply to this work and the project should be notified to the HSE. Under their duty imposed by the CDM Regulations 2007 the designers have attempted to eliminate hazards and risks where possible during design and where hazards and risks could not be avoided the designers have reduced the risks as far as possible. The remaining hazards and foreseeable risks that could not be designed out the project have been identified as below. FALLS: from heights during installation of suspended ceilings, taking deliveries over raised loading bays, as a result of split level floors and steps. HAZARDOUS MATERIALS: i.e. asbestos - to be removed as necessary by specialist, see the <i>Co-operative Groups Management of Asbestos Containing Materials</i> policy and processes. Service providers must comply with the <i>Co-operative Groups Management of Asbestos Containing Materials</i> policy and processes. Service providers are to access the <i>Co-operative Groups web-based asbestos register</i>, www.2650online.co.uk, prior to undertaking any works. Any difficulty in obtaining asbestos information must be brought to our immediate attention and is not an excuse for working without this.</p>	<p>Exceptions Any areas of the proposal that are not in-line with the current model should be detailed here along with the reason and thinking behind it. To also include any by-laws or covenants.</p>	<p>Additional Equipment</p> <table border="1"> <tr><td>VND</td><td>2</td><td>Existing</td><td>Proposed</td></tr> <tr><td>Magazines</td><td>1</td><td></td><td></td></tr> <tr><td>Cards</td><td>1</td><td></td><td></td></tr> <tr><td>Impulse Confect.</td><td>1</td><td></td><td></td></tr> <tr><td>Impulse CSN</td><td>1</td><td></td><td></td></tr> <tr><td>Pizza Step</td><td>1.2</td><td></td><td></td></tr> <tr><td>Bakery</td><td>1</td><td></td><td></td></tr> <tr><td>BWS Prom</td><td>1</td><td></td><td></td></tr> <tr><td>Grocery Prom</td><td>2</td><td></td><td></td></tr> <tr><td>Electrical Shelving</td><td>0</td><td></td><td></td></tr> <tr><td>Roll Cages BOH</td><td>2</td><td></td><td></td></tr> <tr><td>Promo Plinths</td><td>0</td><td></td><td></td></tr> </table>	VND	2	Existing	Proposed	Magazines	1			Cards	1			Impulse Confect.	1			Impulse CSN	1			Pizza Step	1.2			Bakery	1			BWS Prom	1			Grocery Prom	2			Electrical Shelving	0			Roll Cages BOH	2			Promo Plinths	0			<p>Drawing Information</p> <table border="1"> <tr><td>Gross Building Area (GBA)</td><td>Sq. Ft.</td><td>3221 Sq. Ft.</td></tr> <tr><td>Gross Sales Area (GSA)</td><td>Sq. Ft.</td><td>2177 Sq. Ft.</td></tr> <tr><td>Net Sales Area (NSA)</td><td>Sq. Ft.</td><td>2075 Sq. Ft.</td></tr> </table> <p>Back of House Information</p> <table border="1"> <tr><td>Back Of House</td><td>Sq. Ft.</td><td>1044 Sq. Ft.</td></tr> <tr><td>Back Up Chilled</td><td>Sq. Ft.</td><td>112 Sq. Ft.</td></tr> <tr><td>Back Up Frozen</td><td>Sq. Ft.</td><td>88 Sq. Ft.</td></tr> </table> <p>Drawn By: GS Email: graham.shaw@co-operative.coop Scale: 1:50</p> <p>Meetings</p> <table border="1"> <tr><td>Drawing Review</td><td>xx/xx/xxxx</td></tr> <tr><td>Sign Off Meeting</td><td>xx/xx/xxxx</td></tr> </table> <p>Drawing Status: First Review CAD</p>	Gross Building Area (GBA)	Sq. Ft.	3221 Sq. Ft.	Gross Sales Area (GSA)	Sq. Ft.	2177 Sq. Ft.	Net Sales Area (NSA)	Sq. Ft.	2075 Sq. Ft.	Back Of House	Sq. Ft.	1044 Sq. Ft.	Back Up Chilled	Sq. Ft.	112 Sq. Ft.	Back Up Frozen	Sq. Ft.	88 Sq. Ft.	Drawing Review	xx/xx/xxxx	Sign Off Meeting	xx/xx/xxxx	<p>Newhaven Newhaven, Harbourside Fort Rd Newhaven BN9 9EL</p> <p>Store Phone No: Phone No. Format: MTUSS Hub Number: TBC</p> <p>Drawing Information Brief Description of Works: Latest or Proposed Fixture Layout Latest system drawing Job Originated By: Acquisitions Programme 2014</p> <table border="1"> <tr><td>Drawing No:</td><td>STORE-P1</td><td>Fixture Rev:</td><td>M0</td><td>Macro Rev:</td><td>M0</td></tr> </table> <p>The Co-operative Group</p>	Drawing No:	STORE-P1	Fixture Rev:	M0	Macro Rev:	M0
VND	2	Existing	Proposed																																																																																	
Magazines	1																																																																																			
Cards	1																																																																																			
Impulse Confect.	1																																																																																			
Impulse CSN	1																																																																																			
Pizza Step	1.2																																																																																			
Bakery	1																																																																																			
BWS Prom	1																																																																																			
Grocery Prom	2																																																																																			
Electrical Shelving	0																																																																																			
Roll Cages BOH	2																																																																																			
Promo Plinths	0																																																																																			
Gross Building Area (GBA)	Sq. Ft.	3221 Sq. Ft.																																																																																		
Gross Sales Area (GSA)	Sq. Ft.	2177 Sq. Ft.																																																																																		
Net Sales Area (NSA)	Sq. Ft.	2075 Sq. Ft.																																																																																		
Back Of House	Sq. Ft.	1044 Sq. Ft.																																																																																		
Back Up Chilled	Sq. Ft.	112 Sq. Ft.																																																																																		
Back Up Frozen	Sq. Ft.	88 Sq. Ft.																																																																																		
Drawing Review	xx/xx/xxxx																																																																																			
Sign Off Meeting	xx/xx/xxxx																																																																																			
Drawing No:	STORE-P1	Fixture Rev:	M0	Macro Rev:	M0																																																																															

the co-operative food APPENDIX 1